

- LEGEND**
- U.S. NUMBERED HIGHWAY
 - STATE NUMBERED HIGHWAY
 - INTERSTATE HIGHWAY ROUTE
 - PAVED ROAD
 - GRAVEL ROAD
 - GRAVEL & GRADED ROAD
 - UNPAVED ROAD
 - PROJECTED ROAD
 - RESIDENTIAL ROAD
 - COUNTY ROAD ID NO.
 - MILEAGE BETWEEN POINTS
 - DIVIDED HIGHWAY, 4 OR MORE LANES
 - UNDIVIDED HIGHWAY, 3 OR MORE LANES
 - TRAFFIC CIRCLE
 - HIGHWAY GRADE SEPARATION
 - TRAFFIC INTERCHANGE
 - STATE LINE
 - COUNTY LINE
 - CIVIL TOWNSHIP LINE
 - SECTION LINE
 - RURAL DEVELOPMENT AREA
 - CORPORATE LIMITS
 - MATCH LINE
 - COUNTY SEAT
 - TOWNSHIP CENTER
 - CIVIL TOWNSHIP ROAD IN PLACE
 - INSET BOUNDARY
 - ELEVATION ABOVE SEA LEVEL
 - RAILROAD, ANY NUMBER OF TRACKS
 - RAILROAD WITH STATION INDICATED
 - GRADE CROSSING
 - UNDERPASS, R.R. ABOVE
 - OVERPASS, R.R. BELOW
 - RAILROAD ON STREET
 - MILITARY AIRFIELD
 - AIRPORT WITH COMPLETE FACILITIES
 - AIRPORT WITH LIMITED FACILITIES
 - LANDING STRIP, PRIVATE FIELD
 - AIRPORT, GENERAL OUTLINE OF FIELD
 - RUNWAYS SHOWN IN POSITION
 - ROADSIDE PARK
 - PLAYGROUND
 - BATHING BEACH OR SWIMMING POOL
 - SCENIC SITE
 - MOTEL
 - CAMP OR LODGE, Permanent with buildings
 - SMALL PARK, 20-5000, 20-County
 - W.P.A. - Municipal, TP-Trailer Park
 - FOREST RANGER STATION
 - OBSERVATION OR LOOKOUT TOWER
 - CAMP SITE
 - FISH HATCHERY
 - GOLF COURSE OR COUNTRY CLUB
 - ATHLETIC FIELD OR AMUSEMENT PARK
 - FABRICATIONS, RACE COURSE
 - DWELLING
 - NUMBER OF DWELLINGS CLOSELY SPACED
 - COMBINED BUSINESS AND DWELLING
 - POST OFFICE
 - POST OFFICE COMBINATIONS
 - SEASONAL DWELLINGS
 - CHURCH OR OTHER RELIGIOUS BUILDING
 - MOUNTAIN RANGE, BUTTE OR MESA
 - SMALL MOUND
 - MARSH OR SWAMP LANDS
 - DRAINAGE DITCH
 - IRRIGATION DITCH
 - LAKE, RESERVOIR OR POND WITH DAM
 - ROAD OVER DAM
 - DYKE LAKE SUBJECT TO FLOOD
 - SMALL BRIDGES CLOSELY SPACED
 - HIGHWAY BRIDGE, OVER 20 FT. IN LENGTH
 - GENERAL BRIDGE, LONG CROSSING
 - NARROW STREAM
 - ARCH BRIDGE
 - TRUSS BRIDGE, WOODS-STEEL-CONCRETE
 - CONCRETE DIP OR FORD
 - FORD ROAD ESTABLISHED
 - INTERMITTENT STREAM
 - NARROW STREAM
 - DOCK PIER OR LANDING
 - NAVIGABLE STREAM WITH LOCK & DAM
 - WIDE STREAM OR RIVER
 - TRIANGULATION STATION
 - CEMETERY
 - CHURCH WITH CEMETERY ADJACENT
 - REST HOME
 - HOSPITAL
 - SMALL BUSINESS
 - INDUSTRY
 - SAW MILL
 - MINE SHAFT OR DRIFT
 - OIL OR GAS FIELD
 - PALMHOUSE, OR WAREHOUSE STATION
 - WAREHOUSE
 - CANNERY
 - GUMMARY
 - SCHOOL
 - COMMUNITY HALL OR LODGE
 - DRIVE-IN THEATER
 - CORRECTIONAL INSTITUTION
 - HIGHWAY GARAGE
 - JUNK YARDS & DUMPS
 - ROCKSTER STATION
 - POWER PLANT
 - ROCKSTER STATION
 - POWER SUBSTATION
 - TELEVISION OR RADIO STATION
 - MILITARY INSTALLATION

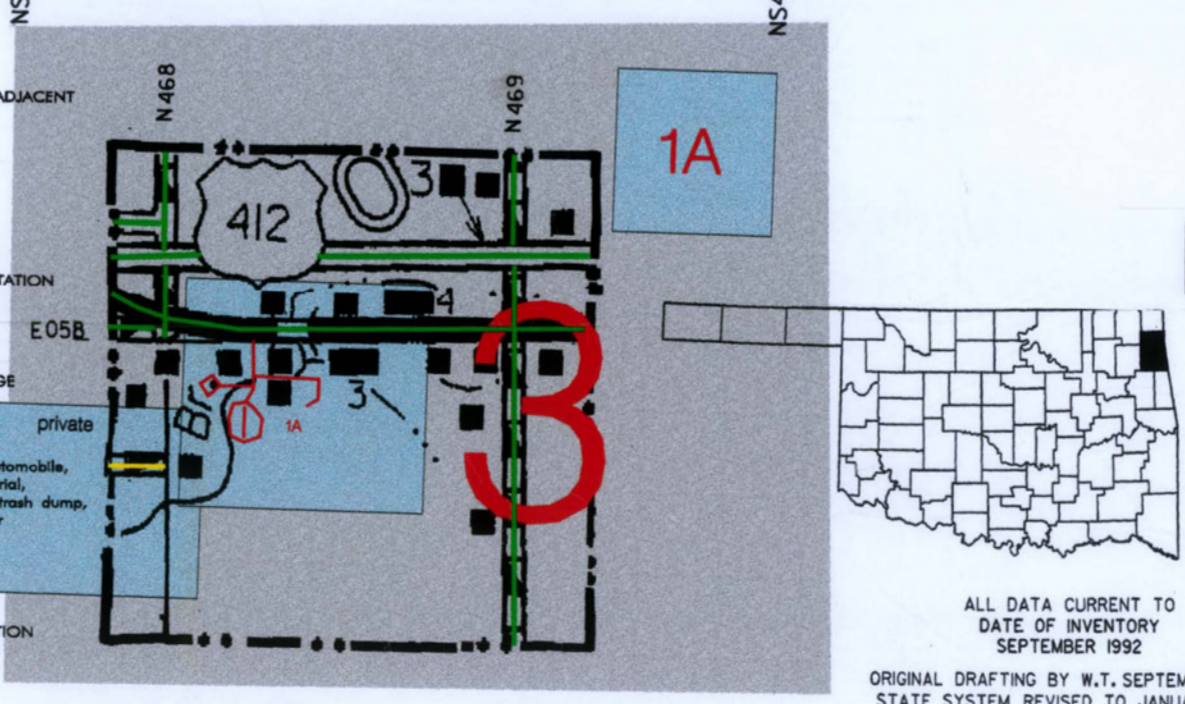

GENERAL HIGHWAY MAP DELAWARE COUNTY OKLAHOMA

PREPARED BY THE
OKLAHOMA DEPARTMENT OF TRANSPORTATION
PLANNING DIVISION

IN COOPERATION WITH THE
U.S. DEPARTMENT OF TRANSPORTATION
FEDERAL HIGHWAY ADMINISTRATION

SCALE
0 1 2 3 4 5 MILES

ALL DATA CURRENT TO
DATE OF INVENTORY
SEPTEMBER 1992
ORIGINAL DRAFTING BY W.T. SEPTEMBER 1995
STATE SYSTEM REVISED TO JANUARY 1998
LAMBERT CONFORMAL CONIC PROJECTION U.S. & GEODETIC SURVEY DATA
20,000 FOOT GRID OKLAHOMA PLANE COORDINATE SYSTEM NORTH PROJECTION ZONE
POPULATION FIGURES BASED ON 1990 U.S. CENSUS
CO. POP. 28,070

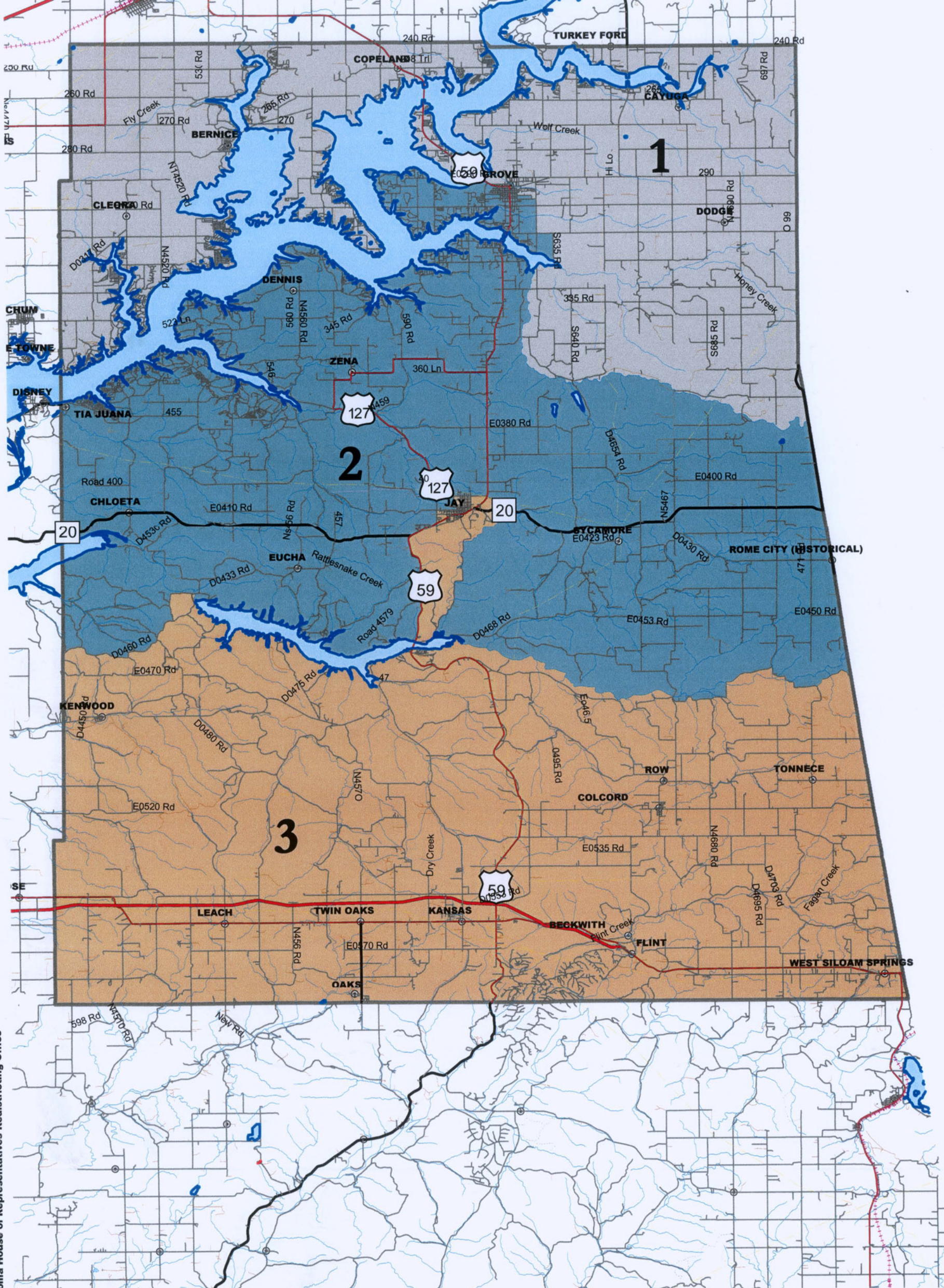

Oklahoma House of Representatives Redistricting Office

Delaware County Commissioner Districts for 2002-2010 Based on the 2000 Census